

## STANDUP Series - Adjustments

The easy tool-free adjustment on the new upright standers makes this operation fast and easy to carry out even by the end user.

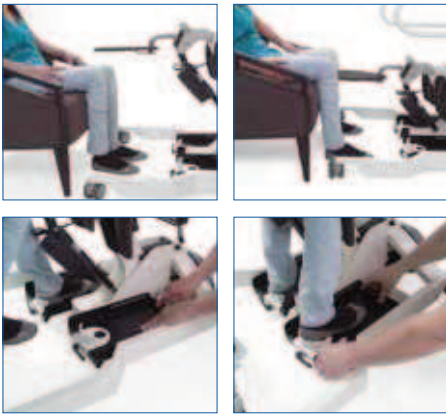

### FOR EASIER ACCESSIBILITY:

<1> Access to the aid is made easier and safer by the alignment of the seat with the original seating position. When transferring from the wheelchair to the standing aid, the seat, unlike the old model, can always remain horizontal and align to the user's seating level by adjusting its height.

<2> The sliding footplates, which are independent and adjustable in depth, reduce the distance between the person in the wheelchair — or sitting — and the base of the structure. This helps transfer the user's feet onto the standing aid. The footplates can be adjusted even when the user is on them.

### 1 - ADJUSTING THE STRUCTURE IN HEIGHT:

the support structure adapts to the user's height easily and with no effort as it is operated electrically or by gas strut. This adjustment can also be made by the user in a quick and easy way, with no need for external help even when they are already standing. The knee, lateral and trunk supports are adjusted accordingly, for greater safety and comfort of the user.

Height adjustment: 200 mm  
Seat minimum height: + 380 mm  
Seat maximum height: + 580 mm

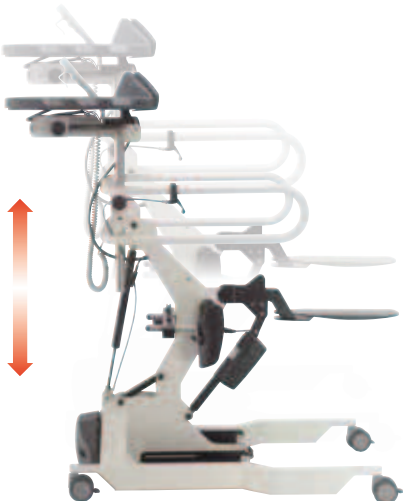

#### Important notes:

- 1 - Adjusting the support structure height also enables a similar adjustment of the shin rests, side handles and tray at the same time.
- 2 - The aid is suitable for users who are between 140 and 200 cm tall and weighing up to 140 kg.

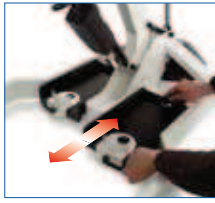

## 2 - ADJUSTING THE FOOTPLATES

All upright standers feature two footplates at the base of the frame. These slide independently from each other so they can be adjusted to meet the wheelchair users' accessibility requirements and improve their posture.

**Depth adjustment: 100 mm**

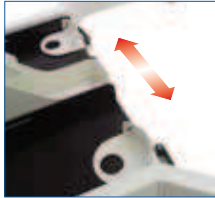

## 3 - ADJUSTING THE HEEL RESTS

Independent depth adjustment for each heel rest. A special accessory strap (ref. code AC0047) can be added to safely position the feet in the footplate.

**Width adjustment: 90 mm x 2**

**Center distance: minimum 206 mm; maximum 386 mm**

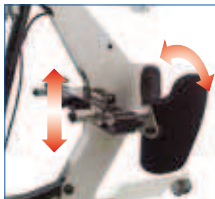

## 4 - ADJUSTING THE SHIN RESTS

The soft and wrap-around shin rests allow the knees to move freely while the user comes to standing. The possible adjustments are as follows:

**Width adjustment: 170 mm; Center distance: min. 210 mm; max 380 mm (independent)**

**Depth adjustment: 100 mm (independent)**

**Height adjustment: 40 mm manually, further 200 mm by servo-adjustment**

**Rotation: +/- 20° (independent)**



## 5 - ADJUSTING THE TRAY

The models from the STAND UP Series have a tray that is adjustable in depth, height and tilt. In the STAND UP models, the tray also doubles as thoracic support.

**Depth adjustment: 140 mm**

**Height adjustment: 300 mm**

The tray height adjustment can also be achieved by adjusting the support structure.

**Note: +/- 200 mm with height adjustment of the structure**

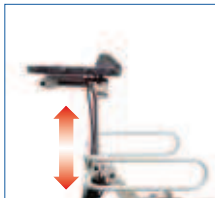

**Tilt adjustment: 5° x 4 = 20°**

